

SHAD

INSTRUCTION MANUAL

SH58X SH59X
Adventure



Daily

From your early mornings
until your late nights



Weekend

For your non-stop getaways



Holidays

Conquer your next adventure



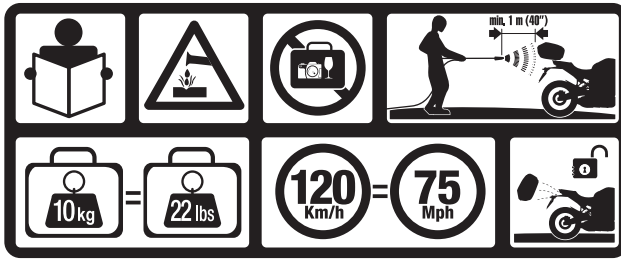

Easy to Expand



1

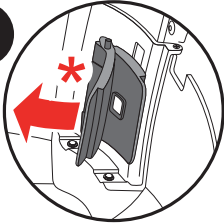

UNLOCK



2



3



LOCK

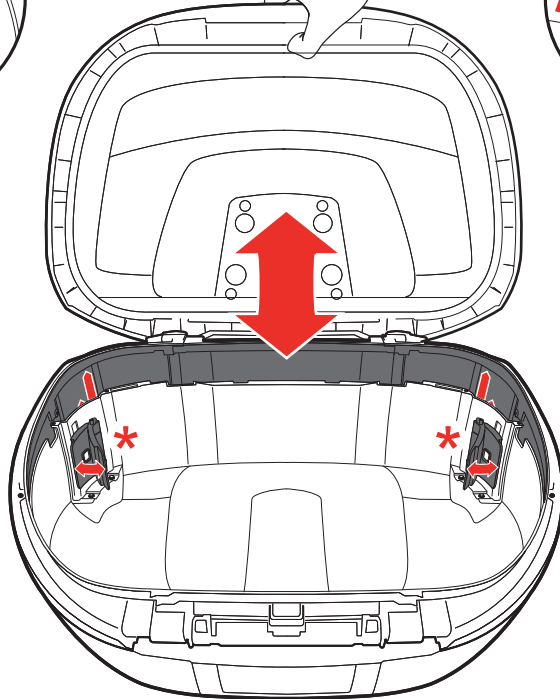

3 POSITIONS:

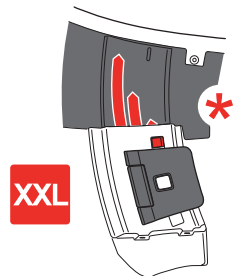
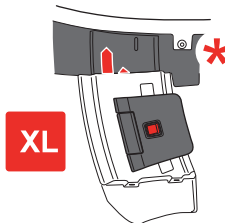
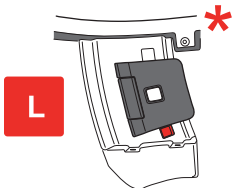

Open

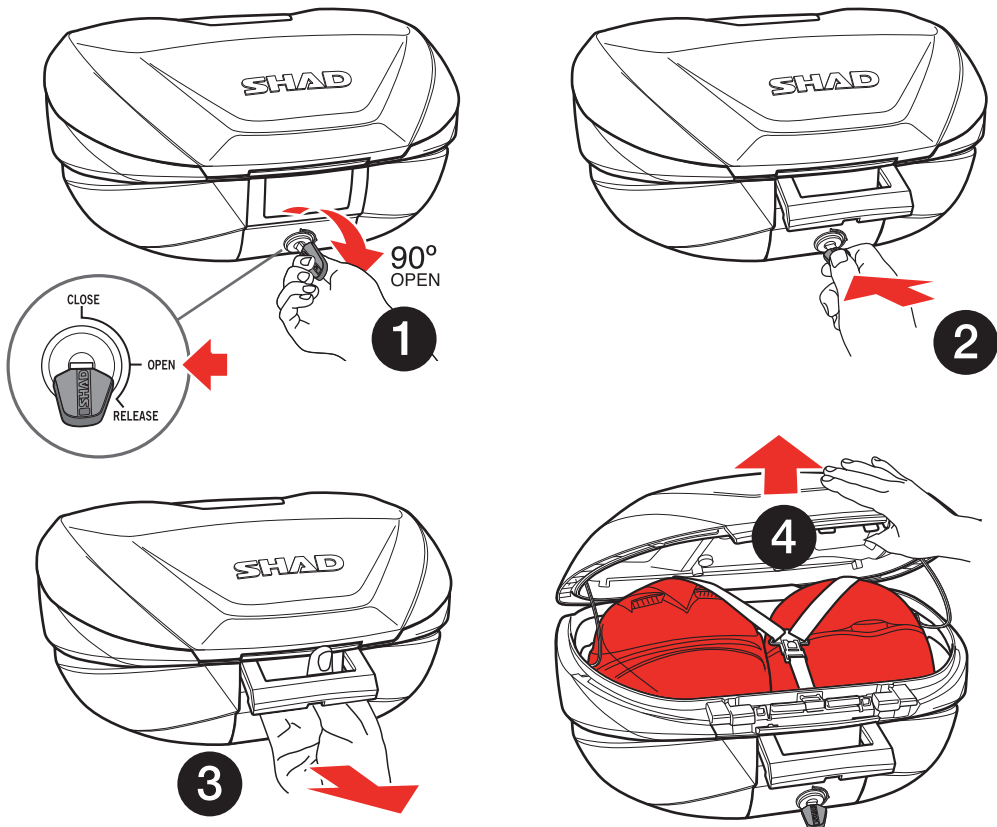

Close

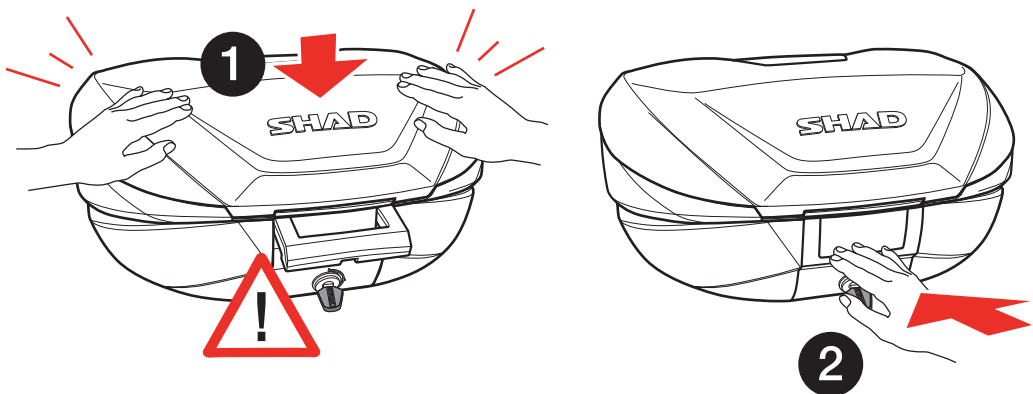

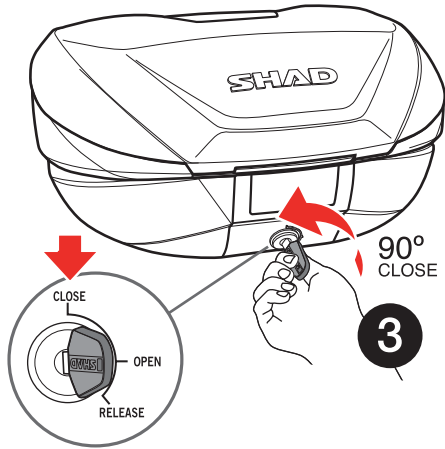

Release

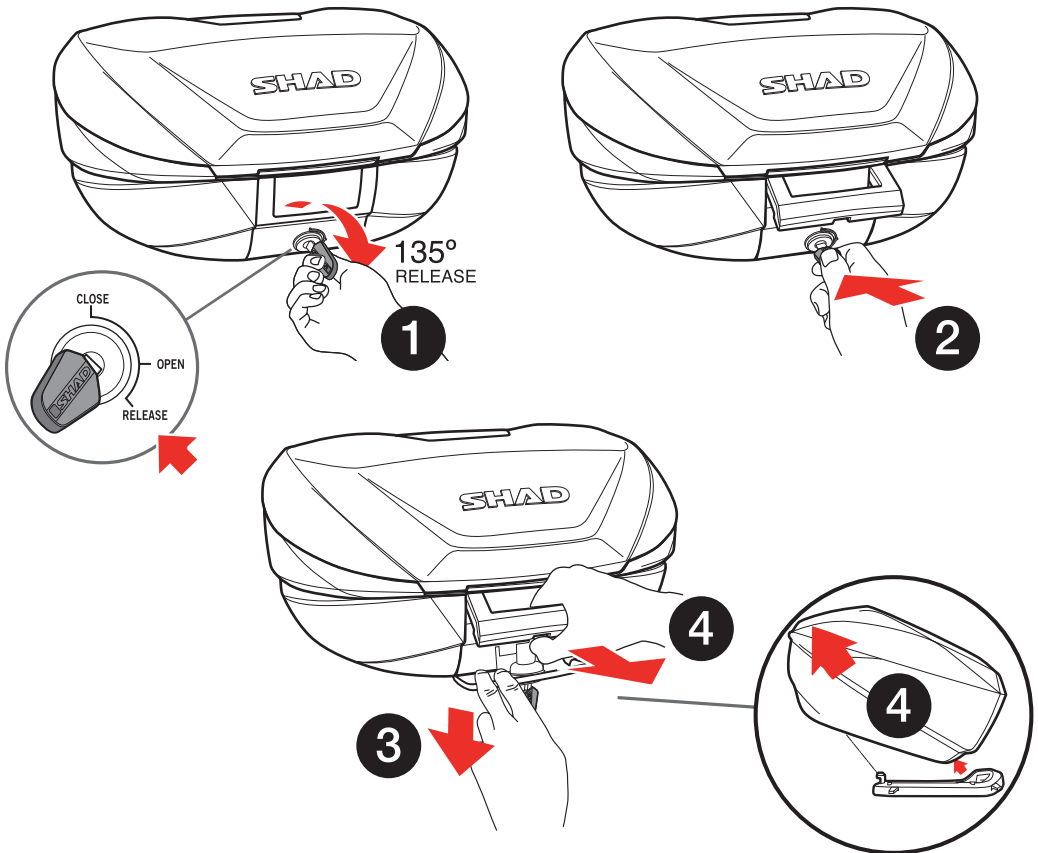

Accessories (Optional)

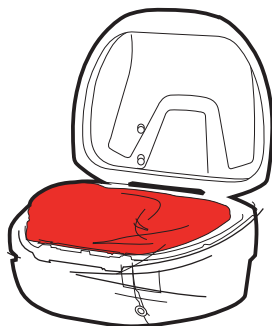

Inner Bag

Ref. X01B10

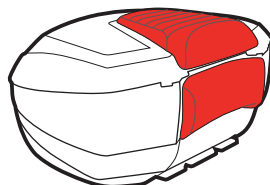

Backrest

Ref. D0R180

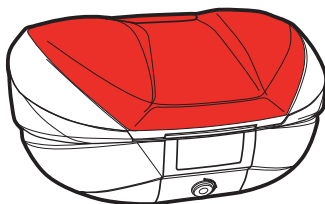

Colour cover

SH58X

Ref. D1B58EXX

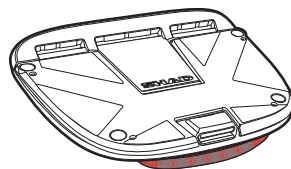

Brake light

Ref. D0B29KL

FAQ's and more information

SH58X



SH59X



One key



For three cases

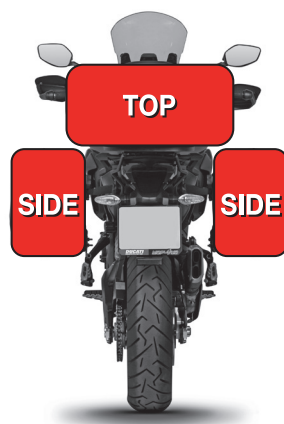

Top case support assembly

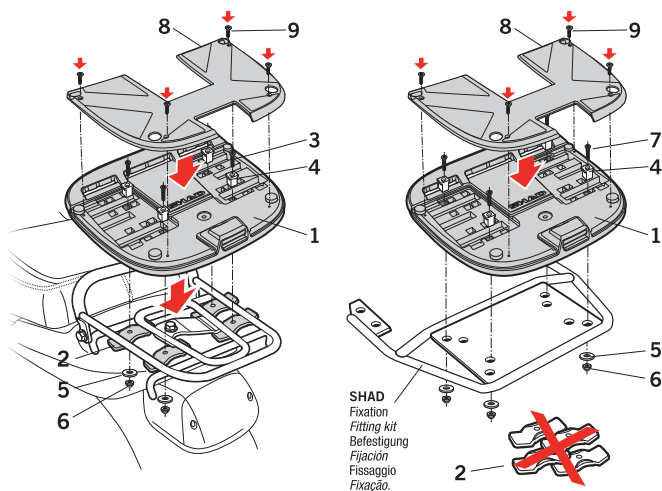

SHAD
Fixation
Fitting kit
Befestigung
Fijación
Fissaggio
Fixação.

Number	Reference	Quantity
1	201834 (Support piece)	1
2	201049 (Bridle)	4
3	304144 (Screw M6x40 DIN 965)	4
4	200713/2 (Plastic bridle)	4
5	303000 (Ø6 Washer fs M6 DIN 125 A)	4
6	302021 (M6 Nut M6 DIN 985)	4
7	304058 (Screw M6x30 DIN 965)	4
8	201835 (Cover support piece)	1
9	304127 (Screw Ø3'5x13 DIN 7982)	4
10	201504 (Metal piece) *	4
11	304074 (Screw M8x20 DIN 912) **	4
12	303020 (Ø8 Washer fs M8 DIN 125 A) **	4
13	302024 (Nut M8 DIN 985) **	4

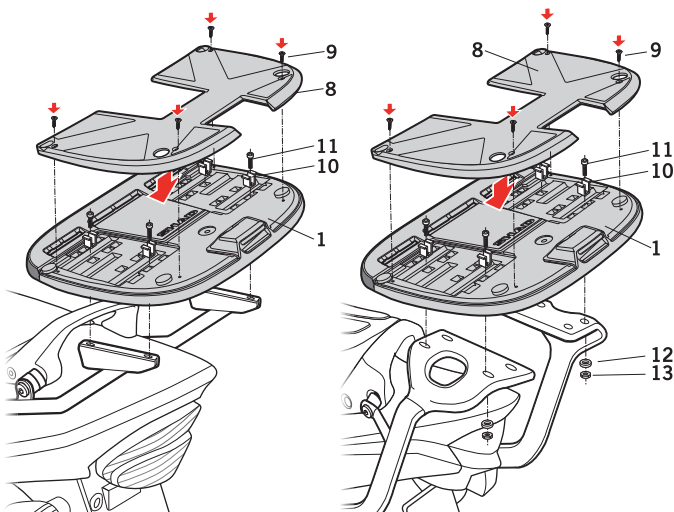

- (GB) Note:** Consult accessories with your distributor.
(*) It can only be used on the Top or Full master.
(**) Included in the specific support.
- (F) Remarque:** Consultez les accessoires avec votre distributeur.
(*) Seulement on pourrait l'utiliser sur le top et le full master.
(**) Inclus dans le support spécifique.
- (D) Anmerkung:** Auslieferer zu dem Zubehör befragen.
(*) Wird nur im Top und Full Master verwendet.
(**) Im spezifischen Halter enthalten.
- (E) Nota:** Consulte accesorios con su distribuidor.
(*) Solo se utilizará sobre el Top y Full Master.
(**) Incluidos en el soporte específico.
- (I) Nota:** Consulti gli accessori con il suo rivenditore.
(*) Solo si utilizzerà sul Top e Full Master.
(**) Inclusi nel supporto specifico.
- (P) Nota:** Consulte a lista de acessórios com o seu distribuidor.
(*) Apenas será utilizado para o Top e Full Master
(**) Incluídos no suporte específico.

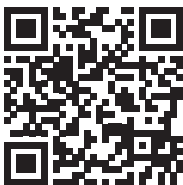

IMPORTANT
WARRANTY INFO: www.shad.es

SHAD
WWW.SHAD.ES

Pol. Ind., Can Magarola
Octave Lecante, 2-6
08100 MOLLET DEL VALLÈS
BARCELONA (SPAIN)

España 0034 935 795 860
France 0034 935 795 868
World 0034 935 795 867
Fax: 0034 935 796 945
info@shad.es